

OPTIONAL COFFEE DECK + SAFETY CLIP FOR SAFETY

Safety is vital in living space of active students. The piece causes deformation of deck and corrosion of lower limb pipe, which causes safety accidents. The safety clip firmly fixes the lower limb pipe and deck without a piece to prevent safety accidents caused by the piece.

STANDS



STAGES



NEW TECHNOLOGY SAFETY CLIP TO HOLD THE SHRINKAGE & EXPANSION OF DECK

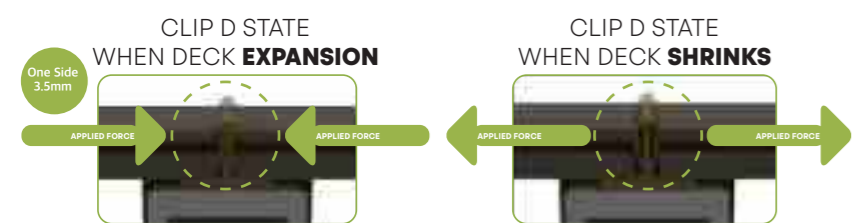

COMPARISON OF DECKS by type

CLASSIFICATION	COFFEE DECK	SYNTHETIC WOOD DECK	NATURAL WOOD (IPE)	
SPECIFICATION (mm)	25T X 150W X 2400L	25T X 150W X 2400L	21T X 90W X 1800L	
FEATURES	MAIN INGREDIENT	Coffee grounds (domestic household waste)	Wooden powder (Vietnam)	Wood (Brazilian)
	ENVIRONMENTAL PROS AND CONS	<ul style="list-style-type: none"> Upcycling of coffee grounds, which is emitted more than 150,000tons per year in Korea, reduces waste and reduces carbon dioxide generation 100% recycled 	<ul style="list-style-type: none"> Use of waste wood the 1st grade wooden powder Dependent on imports Some recycling 	<ul style="list-style-type: none"> Destruction of environment by logging Dependent on imports 100% disposal (incineration)
	FIXED METHOD	Use of the non-piece safety clip	Piece, using clips	Using Piece
MAINTENANCE	Not required	Maintenance is required 1 every 2 years. (Deformation due to shrinkage expansion, etc.)	Oil stain care more than 1 a year (KRW 10,000 per 1㎡ of oil stain)	

COFFEE DECK

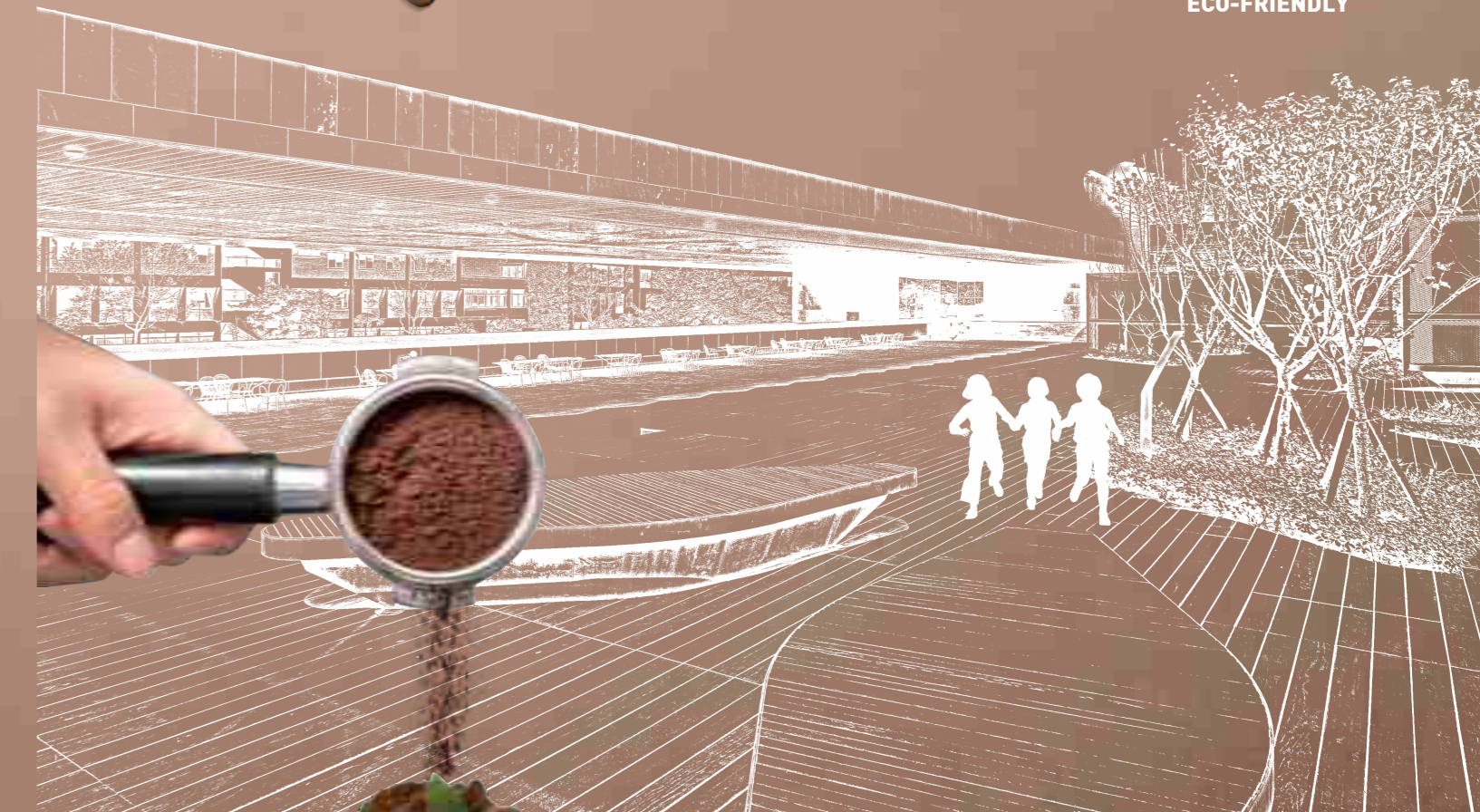

HEAD OFFICE | 71-54, Yangmungongdan-ro 3-gil, Yeongjung-myeon, Pocheon-si, Gyeonggi-do, Republic of Korea

1ST FACTORY | 42-1, Taejanggongdan-gil, Wonju-si, Gangwon-do, Republic of Korea

LABORATORY | #102 410, Jeongseojin-ro, Seo-gu, Incheon, Republic of Korea

www.dongha2006.com

TEL. +82-1588-2118 **FAX.** +82-31-541-0759



WOOD PLASTIC COFFEE DECK

REALIZE CARBON NEUTRALITY & IMPROVE RESOURCE CIRCULATION

Upcycle education activities and resource circulation experience learning that separates coffee grounds from household waste and uses them as decks



OPERATION OF GREEN SCHOOL PROGRAM

CASE OF RESOURCE CIRCULATION EDUCATION

A deck made of coffee grounds creates an opportunity to raise new awareness of resource circulation

Seoul National University of Science and Technology 3rd floor aisle >



ECO-FRIENDLY MATERIALS - COFFEE GROUNDS DECK	
APPLICATION	EFFECTS
Location : Seoul National University of Science and Technology 3rd floor aisle	<ul style="list-style-type: none"> Coffee grounds (coffee residue) circulated with resources at the application site: 15,780 kg (315,600 cups of coffee and circulation of leftover coffee grounds) Effect of reducing greenhouse gas emissions of 109,12kg through circulation of coffee grounds resources (BIO-BEAN survey results - 682kg of greenhouse gas generation per ton of coffee grounds)
Application time : November 2020	
Extent : 1,052m ²	

SUSTAINABLE RESOURCE CIRCULATION OF COFFEE GROUNDS

THE PROCESS OF GENERATING COFFEE GROUNDS

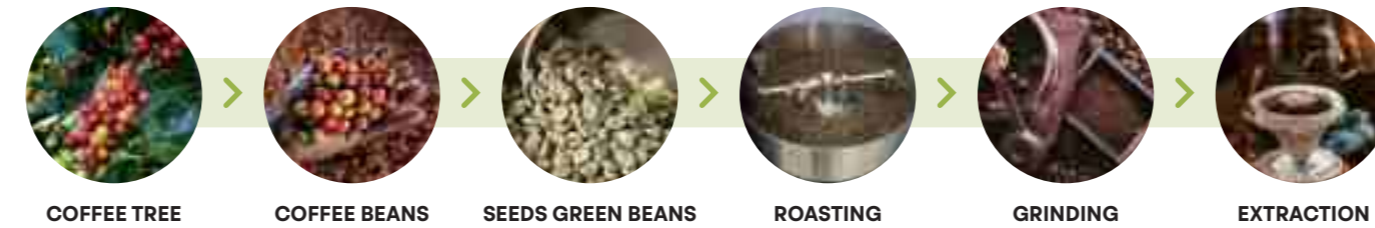

UPCYCLE PROCESS OF COFFEE GROUNDS

